



Buzzing From the Front Door Panels or Speakers

SYMPTOM

Buzzing comes from the door panels or the speakers when the audio system is played at high volume levels.

PROBABLE CAUSE

Speaker vibration causes the door components to make noise.

CORRECTIVE ACTION

To prevent vibration, install EPT sealer, wool felt, and insulator mat between the front door panel and the door on both sides of the vehicle.

TOOL INFORMATION

Audio Diagnostics CD:
T/N 07AAZ-SDBA100

REQUIRED MATERIALS

EPT Sealer 3T:
P/N 06990-SA5-000, H/C 2086643
(Repairs about six vehicles)

EPT Sealer 5T:
P/N 06991-SA5-000, H/C 2086650
(Repairs about two vehicles)

EPT Sealer 10T:
P/N 06992-SA5-000, H/C 2086668
(Repairs about two vehicles)

Wool Felt:
P/N 06993-SA5-000, H/C 2086676
(Repairs about one vehicle)

Insulator Mat:
P/N 72846-282-003AH, H/C 2653384
(Repairs about eight vehicles)

WARRANTY CLAIM INFORMATION

In warranty: The normal warranty applies.

Operation Number: 843008
Flat Rate Time: 1.6 hours
Failed Part: P/N 83500-SEC-A00
Defect Code: 06201
Symptom Code: 04201
Template ID: 04-024A
Skill Level: Repair Technician

Out of warranty: Any repair performed after warranty expiration may be eligible for goodwill consideration by the District Parts and Service Manager or your Zone Office. You must request consideration, and get a decision, before starting work.

DIAGNOSIS

Turn the audio system on, and insert the Audio Diagnostics CD. Set the bass to the maximum setting (+6), and set the volume to 20. Skip to track 13 of the CD, and listen for buzzing from the door panels or speakers.

REPAIR PROCEDURE

- Remove the right front door panel:
 - Refer to page 20-6 of the 2004 TSX Service Manual.

NOTICE

To avoid damage to the door panels, use the proper removal tools and removal procedures. Make sure all the trim panel clips are released before you pull on the door panel.

- In ISIS, enter keyword **FRONT DOOR PANEL**, and select **Front Door Panel Removal/Installation** from the list.
- Remove the door panel bracket and the plastic rain protector from the door.

3. Cut one 100 x 100 mm piece of insulator mat, and attach the piece to the door, as shown.

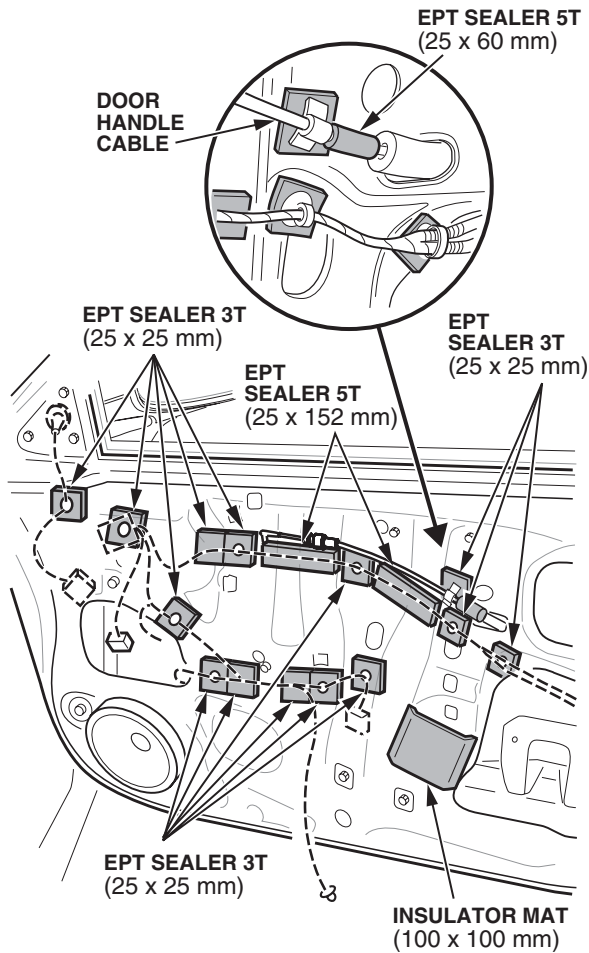

4. Disconnect all the wire harness clips that secure the harness to the door.
5. Cut fourteen 25 x 25 mm pieces of EPT sealer 3T, and cover the holes in the door that hold the wire harness clips, as shown. Open the center of the pieces by gently pushing an awl through the hole that they cover.

NOTICE

To avoid damage to the door or door glass, use care when opening the center of the EPT sealer 3T pieces.

6. Cut two 25 x 152 mm strips of EPT sealer 5T, and attach the strips to the door panel in two places, as shown.
7. Cut one 25 x 60 mm strip of EPT sealer 5T, and wrap the strips around the door handle cable where it enters the door, as shown.

8. Cut one 25 x 75 mm and one 25 x 40 mm strip of EPT sealer 5T, and wrap the strips around the door lock button case and the cable, as shown.

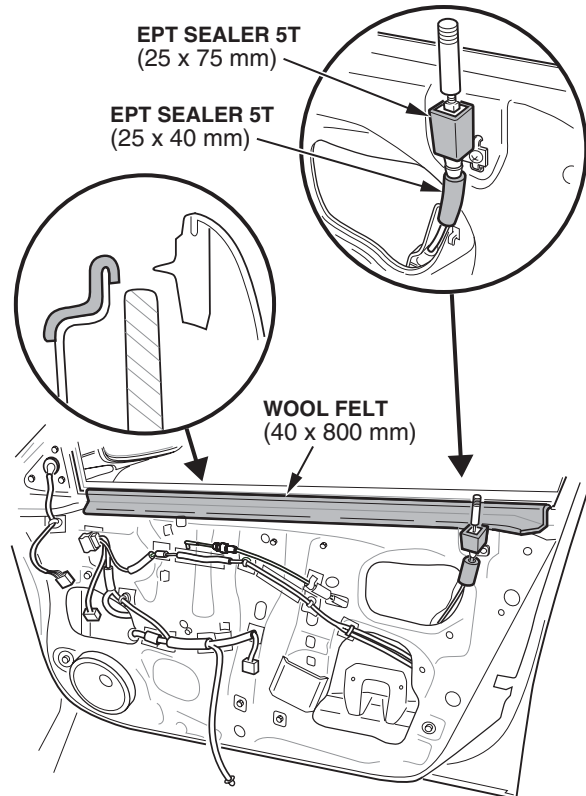

9. Cut one 40 x 800 mm strip of wool felt, and attach it to the top of the door where the door panel hooks onto the door. Apply the strip so about 15 mm of the wool felt strip wraps over the top of the door.

10. Reinstall the plastic rain protector and the door panel bracket.

11. Cut five 20 x 200 mm strips of EPT sealer 10T, and apply them to the plastic rain protector as shown.

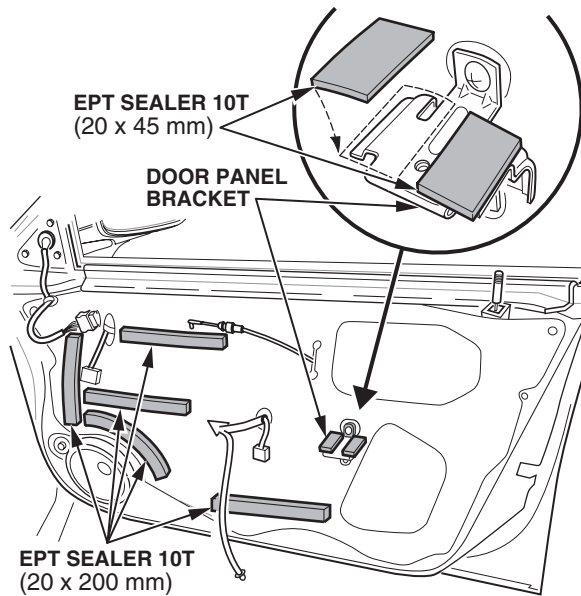

12. Cut two 20 x 45 mm strips of EPT sealer 10T, and apply them to the door panel bracket, as shown.

13. Cut these pieces of EPT sealer and wool felt, and apply them to the inside portion of the door panel, as shown:

- One 40 x 50 mm strip of EPT sealer 5T.
- One 50 x 70 mm strip of EPT sealer 5T.
- One 100 x 140 mm strip EPT sealer 5T.
- One 100 x 180 mm strip of EPT sealer 5T.
- One 20 x 140 mm strip of EPT sealer 10T.
- One 20 x 250 mm strip of EPT sealer 10T.
- One 15 x 600 mm strip of wool felt.

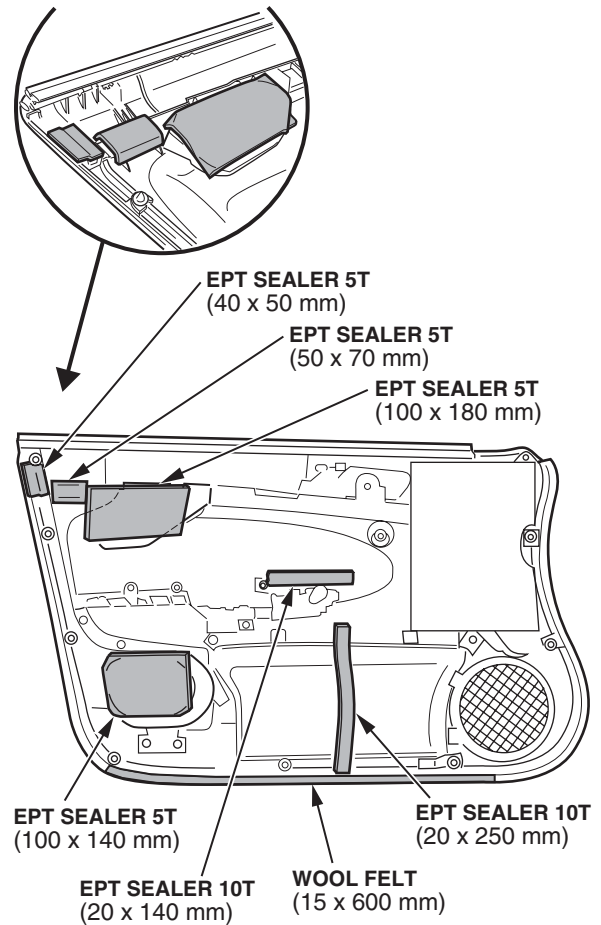

14. Inspect the door panel for damage, and reinstall the door panel. Check the operation of the door.

15. Retest for buzzing from the doors or speakers with the audio diagnostic CD.

16. Repeat steps 1 thru 15 on the left front door.