



Applies To: 2009 TSX – ALL

June 4, 2008

Fuel Fill Door Is Hard To Open

SYMPTOM

When the fuel fill door is pressed, the release latch does not disengage.

PROBABLE CAUSE

Not enough clearance in the fuel door lock tab.

CORRECTIVE ACTION

Trim 1 mm of material from the top of the fuel door lock tab.

WARRANTY CLAIM INFORMATION

In warranty: The normal warranty applies.

Operation Number: 3100A3

Flat Rate Time: 0.2 hour

Failed Part: P/N 74480-TL0-G00

Defect Code: 03001

Symptom Code: 01201

Template ID: 08-025A

Skill Level: Repair Technician

Out of warranty: Any repair performed after warranty expiration may be eligible for goodwill consideration by the District Parts and Service Manager or your Zone Office. You must request consideration, and get a decision, before starting work.

DIAGNOSIS

Verify that the fuel fill door is hard to open. The door can be intermittently hard to open, and occurs usually when the door has not been opened for one or more days.

REPAIR PROCEDURE

1. Trim 1 mm of material from the top of the fuel door lock tab with a pair of sharp diagonal cutters.

FUEL DOOR LOCK TAB

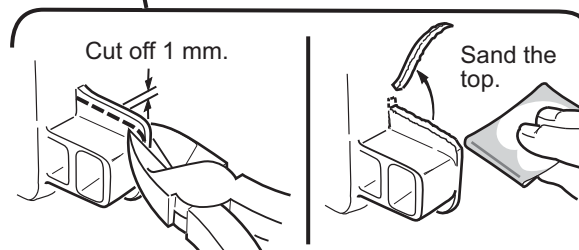

2. Smooth the top of the tab with sandpaper or emery cloth.