

RESTRICTED

The information given in this document is not to be communicated, either directly or indirectly, to the Press or to any person not authorized to receive it.

**IDENTIFICATION LIST
FOR
PISTOL, REVOLVER, WEBLEY,
·38-INCH, MARK 4.**

**1947
SECTION B.I.**

**APRIL 1947.
THE WAR OFFICE
E.B. 962**

By Command of the Army Council

Eric B.B. Reed.

PREFACE

This list has the principal parts of the equipment arranged alphabetically, the components of these parts being shown indented under their appropriate heading.

Each item is identified by a designation (i.e. the noun and any other words on the same line) and a catalogue number.

All items indented under an assembly or sub-assembly designation, are to be regarded as integral parts of the assembly etc.

Every item and assembly is shown in the text, and each is given a plate reference number. The numbers which do not appear on the plates are indicated thus /.

The equipment is divided into a number of groups each capable of being dealt with on one page of the text. To each of these groups an identification letter is allotted. The key plate facing page IV displays these letters with arrows indicating the various groups.

The Section Letter and number indicated against Catalogue numbers denotes the issuing section e.g. - B1/BB 7033 = V.A.O.S. Section B1 Catalogue number BB 7033.

Items provided for normal maintenance and held in Ordnance stores for issue, are indicated thus %.

Note. - All dimensions are in inches except where otherwise stated.

INSTRUCTIONS WHEN SUBMITTING INDENTS AND DEMANDS

1. Identify part required by its designation in column 2, and note its catalogue number in column 3.
2. Quote the vocabulary section at the head of indent or demand sheet, then show the catalogue number, the designation or part thereof as shown in capitals and quantity of the item required. The nature and mark of the Pistol, Revolver will be shown as remarks.
3. When indenting or demanding by telegram or telephone, the code shown in the top right hand corner of the cover, the catalogue number, the noun only, and the quantity of the item required, will be quoted.

The following abbreviations are used :-

A.C.I. - Army Council Instruction
Amendt. - Amendment
Cat. - Catalogue
Contd. - Continued
In. - Inch
Mk. - Mark

No. - Number
Patt. - Pattern
Ref. - Reference
Sect. - Section
W.E. - Webbing Equipment

It is essential that the list should be kept carefully amended and the particulars recorded below.

AMEND'T SERIAL NO.	A.C.I.	BY WHOM AMENDED	DATE OF INSERTION	AMEND'T SERIAL NO.	A.C.I.	BY WHOM AMENDED	DATE OF INSERTION

Any correspondence with reference to this list should be addressed to Chief Inspector of Armaments.

CONTENTS

	<u>Page No.</u>
Accessories -	
Equipment, webbing	4
Lanyard, pistol	4
Rod, cleaning	4
Tools, armourer's	4
Index to catalogue numbers	5
Pistol, revolver, Webley, .38-in., Mk. 4 -	
Barrel	1
Body	1
Cylinder	1
Hammer	2
Levers	2
Springs	3
Stock	3
Stop, cylinder	3
Trigger	3

INDEX TO KEY PLATE

<u>Plate</u>		<u>Facing Page</u>
	Pistol, revolver, webley, .38-in., Mk.4 -	
A	Barrel	1
A	Body	1
A	Catch, barrel	1
A	Cylinder	1
B	Hammer	2
B	Levers	2
C	Stock	3
C	Trigger	3

KEY PLATE.

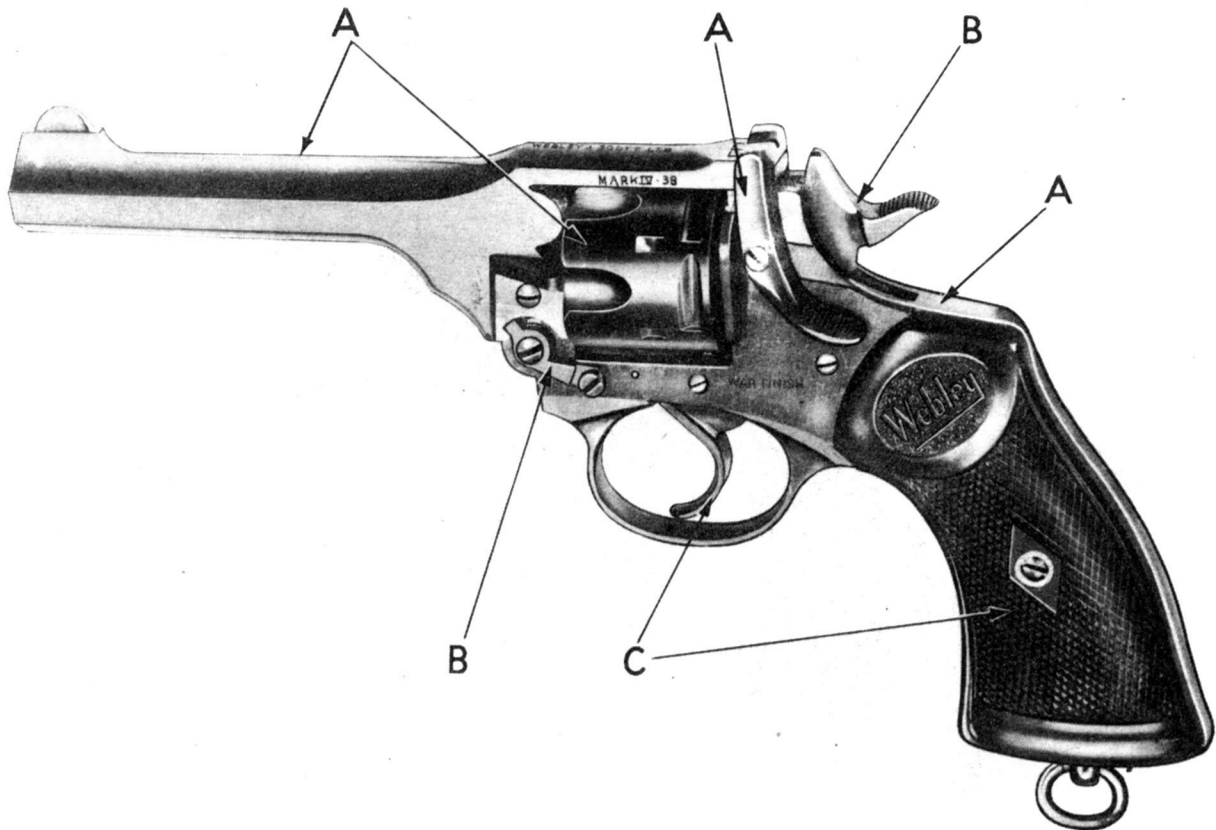

PLATE REF. NO	DESIGNATION	V.A.O.S SECT. & PART OR CAT. NO	NO OFF	DRAWING NO
A				<u>D5(E)</u>
1	PISTOL, REVOLVER, WEBLEY, .38-IN., MK.4 †	B1/CR 5GA	1	1861/G/74 <u>WEBLEY & SCOTT LTD</u>
2	BARREL †	B1/BB 7034	1	
3	AXIS, cylinder	B1/BB 7093	1	MK IV 38G/2B
4	BARREL	B1/BA 10124	1	MK IV 38G/2
5	BODY	B1/BB 7033	1	MK IV 38G/1
6	CAM, cylinder %	B1/BB 7048	1	MK IV 38G/16
7	CATCH, barrel %	B1/BB 7035	1	MK IV 38G/3
8	CUP, countersunk	B1/BA 10125	1	MK IV 38G/41
9	CYLINDER †	B1/BB 7047	1	
10	CYLINDER	B1/BA 10126	1	MK IV 38G/15B
11	EXTRACTOR	B1/BA 10127	1	MK IV 38G/15D
12	NUT †	B1/BA 10128	1	MK IV 38G/15C
13	NUT, extractor	B1/BB 7072	1	MK IV 38G/32
14	PIN, extractor † %	B1/BB 7092	1	MK IV 38G/15E
15	PIN, fixing, nut †	B1/BA 10129	1	MK IV 38G/15F
16	SPRING, extractor † %	B1/BB 7074	1	MK IV 38G/34
17	GUARD, trigger	B1/BB 7056	1	MK IV 38G/24

DETAILS.

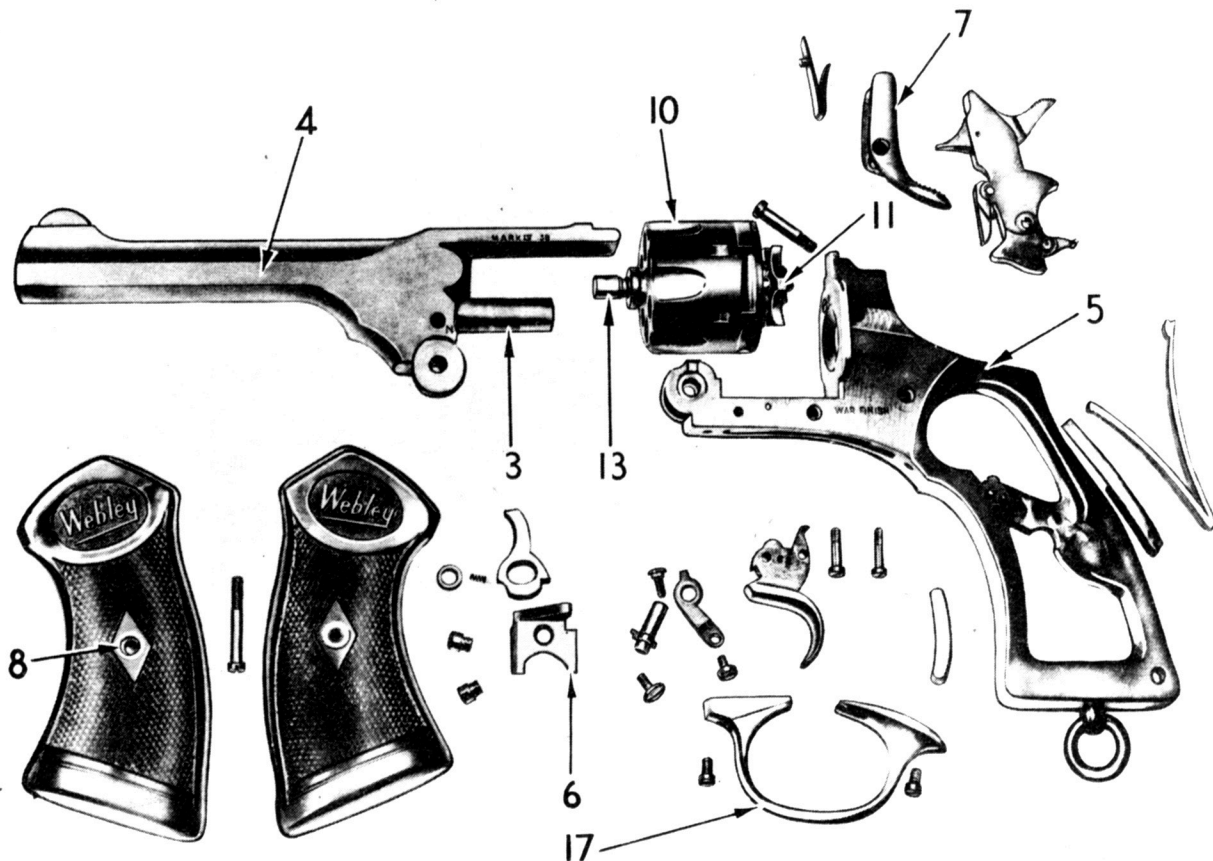

PLATE REF. NO	DESIGNATION	V.A.O.S SECT. & PART OR CAT. NO	NO OFF	DRAWING NO
	PISTOL, REVOLVER, WEBLEY, .38-IN., MK.4 (contd.) -			<u>WEBLEY & SCOTT LTD.</u>
B				
1	HAMMER / %	BL/BB 7038	1	
2	CATCH %	BL/BB 7039	1	MK. IV 38G/7
3	HAMMER	BL/BA 10130	1	MK. IV 38G/6
4	PIN, striker... .. %	BL/BB 7045	1	MK. IV 38G/13
5	SCREW, catch... ..	BL/BB 7043	1	MK. IV 38G/11
6	SCREW, swivel %	BL/BB 7044	1	MK. IV 38G/12
7	SPRING, catch %	BL/BB 7046	1	MK. IV 38G/14
8	STRIKER %	BL/BB 7041	1	MK. IV 38G/9
9	SWIVEL %	BL/BB 7040	1	MK. IV 38G/8
10	LEVER, cam %	BL/BB 7078	1	MK. IV 38G/38
11	LEVER, extractor %	BL/BB 7071	1	MK. IV 38G/31
12	LEVER, main spring %	BL/BB 7059	1	MK. IV 38G/27
13	NUT, stock screw	BL/BA 10131	1	MK. IV 38G/49
14	PAWL %	BL/BB 7060	1	MK. IV 38G/28
15	PIN, positioning, stock	BL/BB 7090	1	MK. IV 38G/48
16	PIN, joint %	BL/BB 7087	1	MK. IV 38G/45
17	PIN, axis, cylinder stop... ..	BL/BB 7052	1	MK. IV 38G/20
18	PIN, swivel, butt	BL/BB 7090	1	MK. IV 38G/48
19	ROLLER, extractor lever %	BL/BB 7073	1	MK. IV 38G/33
20	SCREW, cylinder cam %	BL/BB 7054	2	MK. IV 38G/22
21	SCREW, barrel catch %	BL/BB 7036	1	MK. IV 38G/4
22	SCREW, fixing, cam lever... .. %	BL/BB 7084	1	MK. IV 38G/40
23	SCREW, trigger guard %	BL/BB 7058	2	MK. IV 38G/26
24	SCREW, hammer %	BL/BB 7042	1	MK. IV 38G/10

DETAILS.

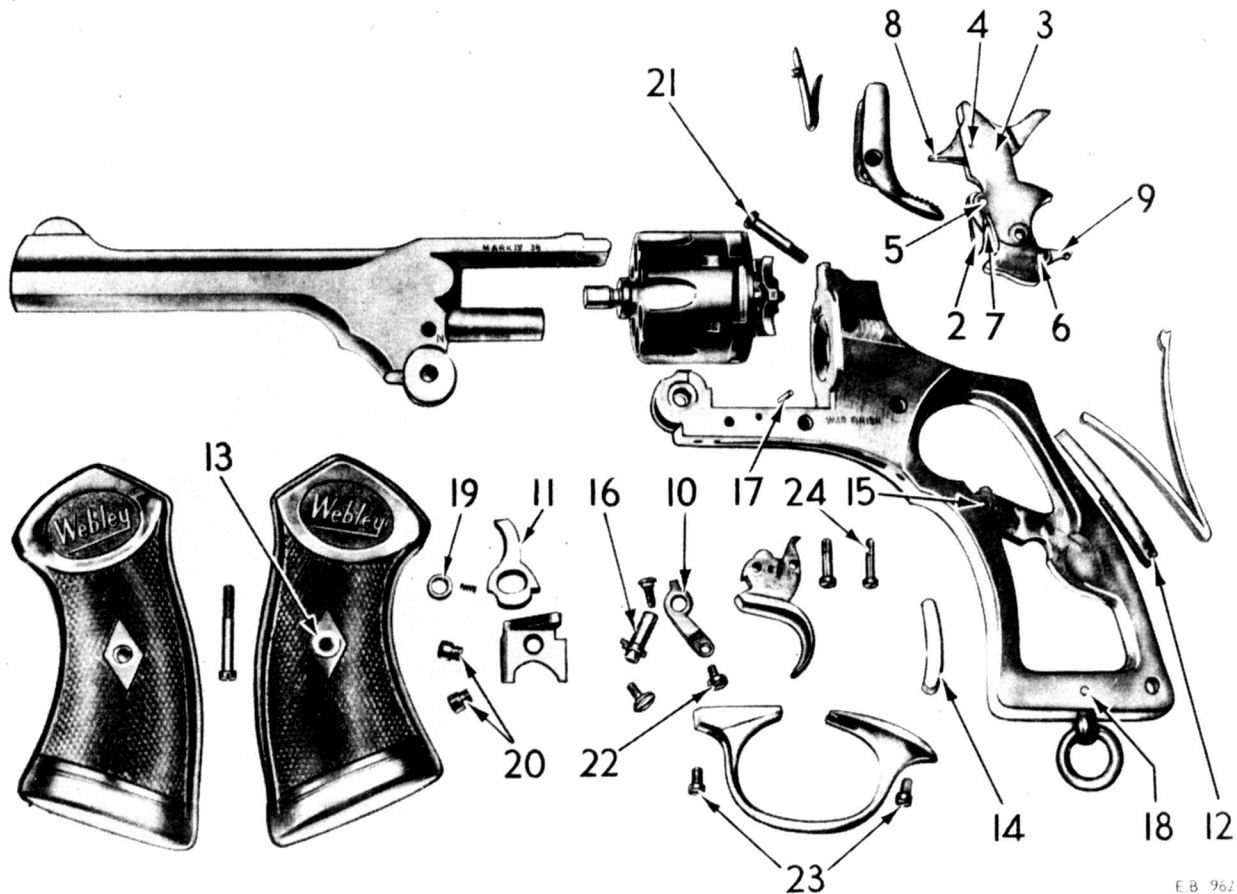

PLATE REF. NO	DESIGNATION	V.A.O.S SECT. & PART OR CAT. NO	NO OFF	DRAWING NO
C	PISTOL, REVOLVER, WEBLEY .38-IN., MK.4 (contd.) -			<u>WEBLEY & SCOTT LTD.</u>
1	SCREW, cam lever %	B1/BB 7079	1	Mk.IV 38G/39
2	SCREW, joint pin %	B1/BB 7088	1	Mk.IV 38G/46
3	SCREW, shield / %	B1/BB 0458	1	Mk.IV 38G/30
4	SCREW, stock %	B1/BB 7089	1	Mk.IV 38G/47
5	SCREW, trigger %	B1/BB 7057	1	Mk.IV 38G/25
6	SHIELD %	B1/BB 7061	1	Mk.IV 38G/29
7	SPRING, barrel catch %	B1/BB 7037	1	Mk.IV 38G/5
8	SPRING, extractor lever %	B1/BB 7075	1	Mk.IV 38G/35
9	SPRING, main %	B1/BB 7085	1	Mk.IV 38G/43
10	SPRING, cylinder stop %	B1/BA 10132	1	Mk.IV 38G/19E
11	STOCK, left side (a) %	B1/BA 10133	1	Mk.IV 38G/51
12	STOCK, right side (a) %	B1/BA 10134	1	Mk.IV 38G/51
13	STOP, CYLINDER / %	B1/BA 10135	1	Mk.IV 38G/17
14	PIN, plunger %	B1/BB 7053	1	Mk.IV 38G/21
15	PLUNGER %	B1/BB 7050	1	Mk.IV 38G/18
16	SPRING, plunger %	B1/BB 7051	1	Mk.IV 38G/19
17	STOP %	B1/BB 7049	1	Mk.IV 38G/17A
18	SWIVEL, butt %	B1/BB 7086	1	Mk.IV 38G/44
19	TRIGGER %	B1/BB 7055	1	Mk.IV 38G/23
	(a) Held and issued in pairs under Cat.No. B1/BB 7091			

DETAILS.

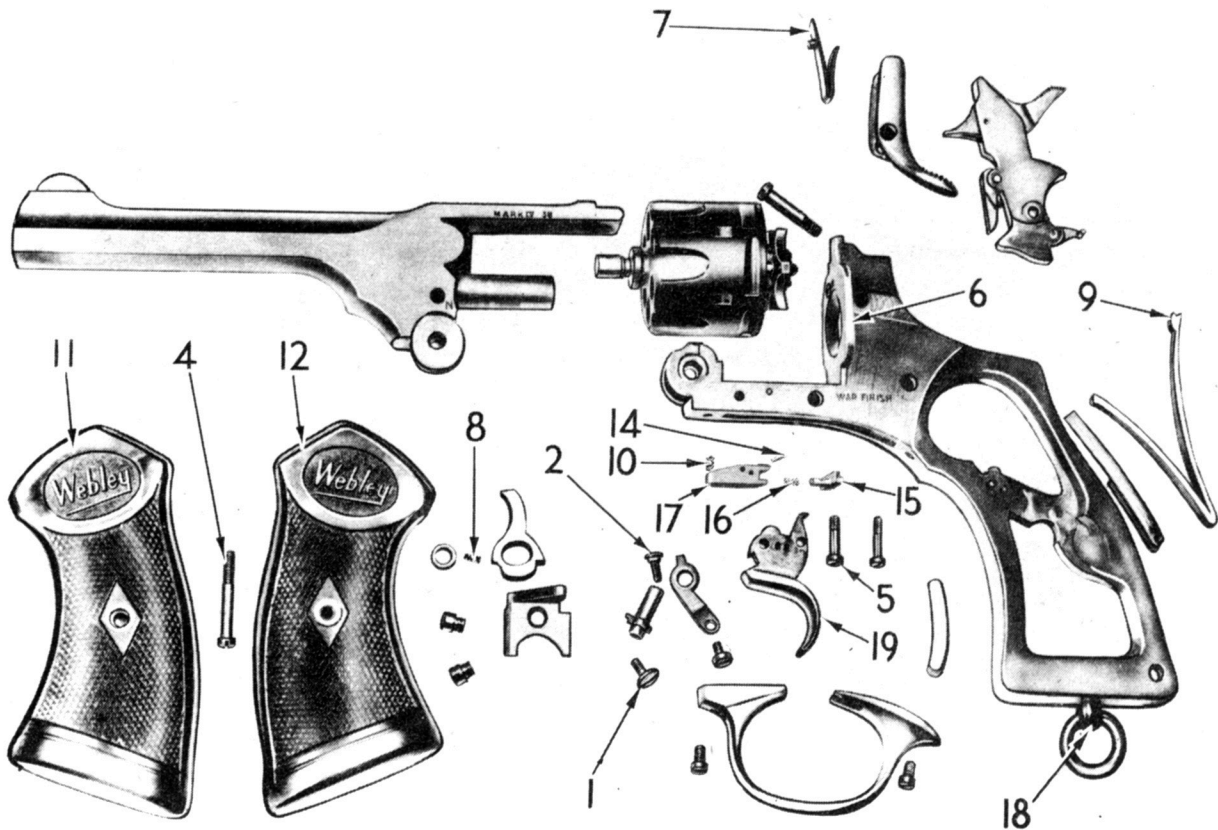
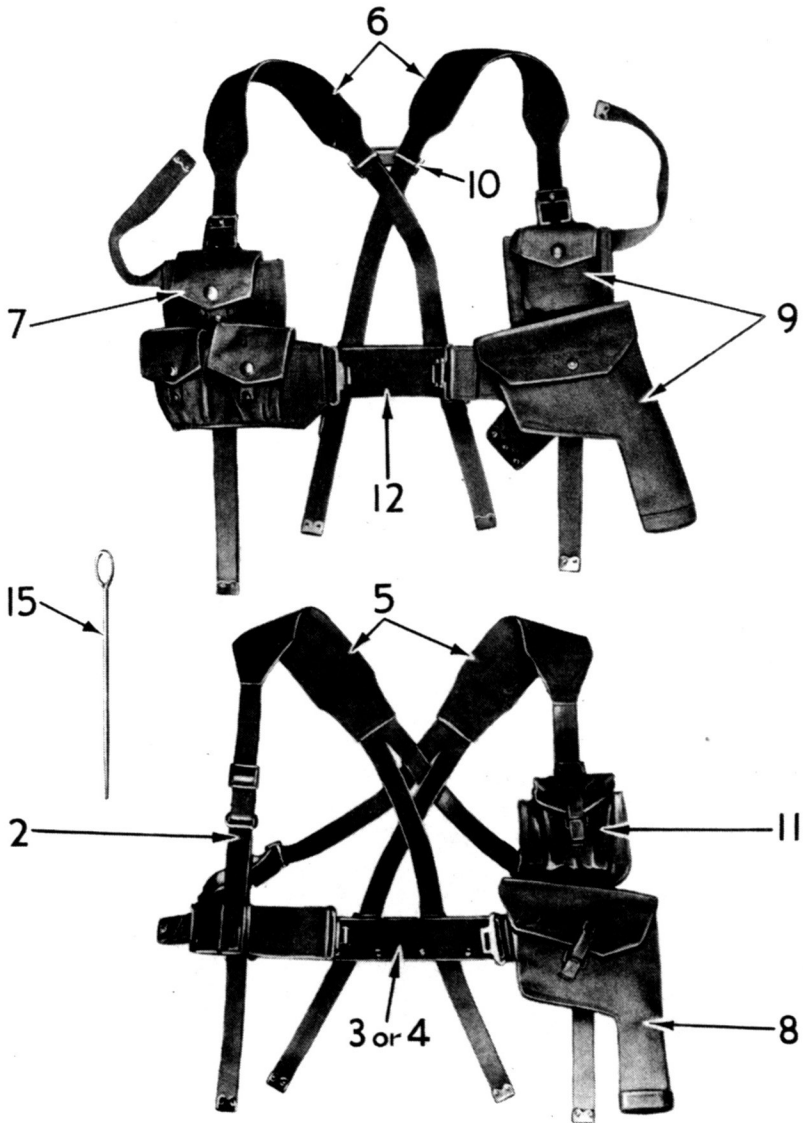

PLATE REF. NO	DESIGNATION	V.A.O.S SECT. & PART OR CAT. NO	NO OFF	DRAWING NO
D	ACCESSORIES			
1	EQUIPMENT, WEBBING - /			
2	ATTACHMENT, BRACE, W.E. PATT '44	A1/AA 2000	2	
3	BELT, WAIST, W.E. PATT '44 LARGE	A1/AA 2001	1	
4	BELT, WAIST, W.E. PATT '44 NORMAL	A1/AA 2002	1	
5	BRACE, W.E. PATT '44	A1/AA 2003	1	
6	BRACE, W.E. CAVALRY, PATT '40	A1/AA 5295	2	
7	CARRIER, CARTRIDGE, W.E. CAVALRY PATT '40, 45 ROUNDS RIGHT	A1/AA 5297	1	
8	CASE, PISTOL, W.E. PATT '44	A1/AA 2005	1	
9	CASE, PISTOL, W.E. CAVALRY PATT '40	A1/AA 5304	1	
10	FITTING, BRASS, W.E. CAVALRY PATT '40	A1/AA 5299	1	
11	POUCH, AMMUNITION, PISTOL, W.E. PATT '44	A1/AA 2010	1	
12	STRAP, BACK ADJUSTMENT, W.E. CAVALRY PATT '40	A1/AA 5302	1	
13	FLANNELETTE, 4-INS. WIDE /	B2/BC 3491	1	
14	LANYARD, PISTOL /	B1/AA 1160	1	
15	ROD, CLEANING, PISTOL, NO. 2, MK. 1	B1/BB 3911	1	S.A.I.D. 833C
16	TOOLS, ARMOURERS - /			
17	BRACE, ARMOURER'S, MK. 3 /	B2/BC 3052	1	
18	BIT, cleaning, No. 2 /	B2/BC 3056	1	
19	WIRE, ARMOURER'S, BRASS, 3-IN. LENGTHS /	B2/BC 4127	1	

ACCESSORIES.



CATALOGUE NUMBER	PAGE	CATALOGUE NUMBER	PAGE	CATALOGUE NUMBER	PAGE
AA 1160	4	BB 7036	2	BB 7085	3
AA 2000	4	BB 7037	3	BB 7086	3
AA 2001	4	BB 7038	2	BB 7087	2
AA 2002	4	BB 7039	2	BB 7088	3
AA 2003	4	BB 7040	2	BB 7089	3
AA 2005	4	BB 7041	2	BB 7090	2
AA 2010	4	BB 7042	2	BB 7092	1
AA 5295	4	BB 7043	2	BB 7093	1
AA 5297	4	BB 7044	2		
AA 5299	4	BB 7045	2		
AA 5302	4	BB 7046	2	BC 3052	4
AA 5304	4	BB 7047	1	BC 3056	4
		BB 7048	1	BC 3491	4
		BB 7049	3	BC 4127	4
		BB 7050	3		
BA 10124	1	BB 7051	3		
BA 10125	1	BB 7052	2		
BA 10126	1	BB 7053	3		
BA 10127	1	BB 7054	2		
BA 10128	1	BB 7055	3		
BA 10129	1	BB 7056	1		
BA 10130	2	BB 7057	3		
BA 10131	2	BB 7058	2		
BA 10132	3	BB 7059	2		
BA 10133	3	BB 7060	2		
BA 10134	3	BB 7061	3		
BA 10135	3	BB 7071	2		
		BB 7072	1		
		BB 7073	2		
BB 0458	3	BB 7074	1		
BB 3911	4	BB 7075	3		
BB 7033	1	BB 7078	2		
BB 7034	1	BB 7079	3		
BB 7035	1	BB 7084	2		
				<u>PART NUMBER</u>	
				CR 5 GA	1

