

BLADES, FORESIGHT. LEFT CENTRAL RIGHT.

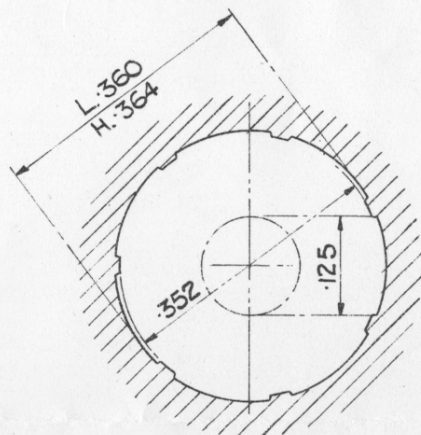

DIA. OF BORE	.352.
DIA. OF RIFLING	L. .360, H. .364
WIDTH OF GROOVE	.125
TWIST OF RIFLING	1 TURN IN 15 INS. R.H.
Nº OF GROOVES	7

SECTION OF RIFLING.
SCALE:- 4/1.

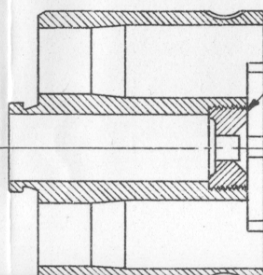
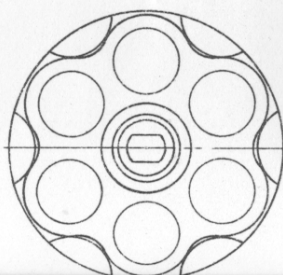

NUT, CYLINDER

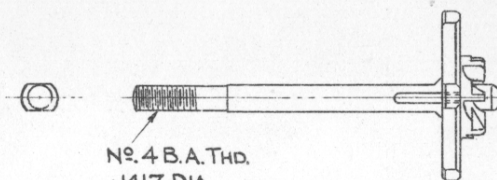
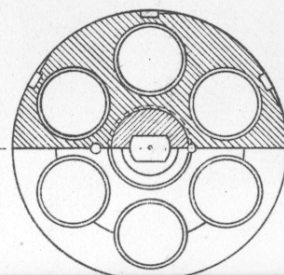

Nº. 4 B.A. THD.
.1417 DIA.